

LEGAL DESCRIPTION:
 LOTS 16 & 17 OF NORTHVILLE GARDENS, A RE-SUBDIVISION OF
 LOTS 12 & 13 OF KNAPP'S SUBDIVISION A PART OF S.E. 1/4 OF
 SEC. 4, TOWN 1 SOUTH, RANGE 8 EAST, TOWNSHIP OF NORTHVILLE,
 WAYNE COUNTY, MICHIGAN, AS RECORDED IN LIBER 66, PAGE 22
 OF WAYNE COUNTY RECORDS.

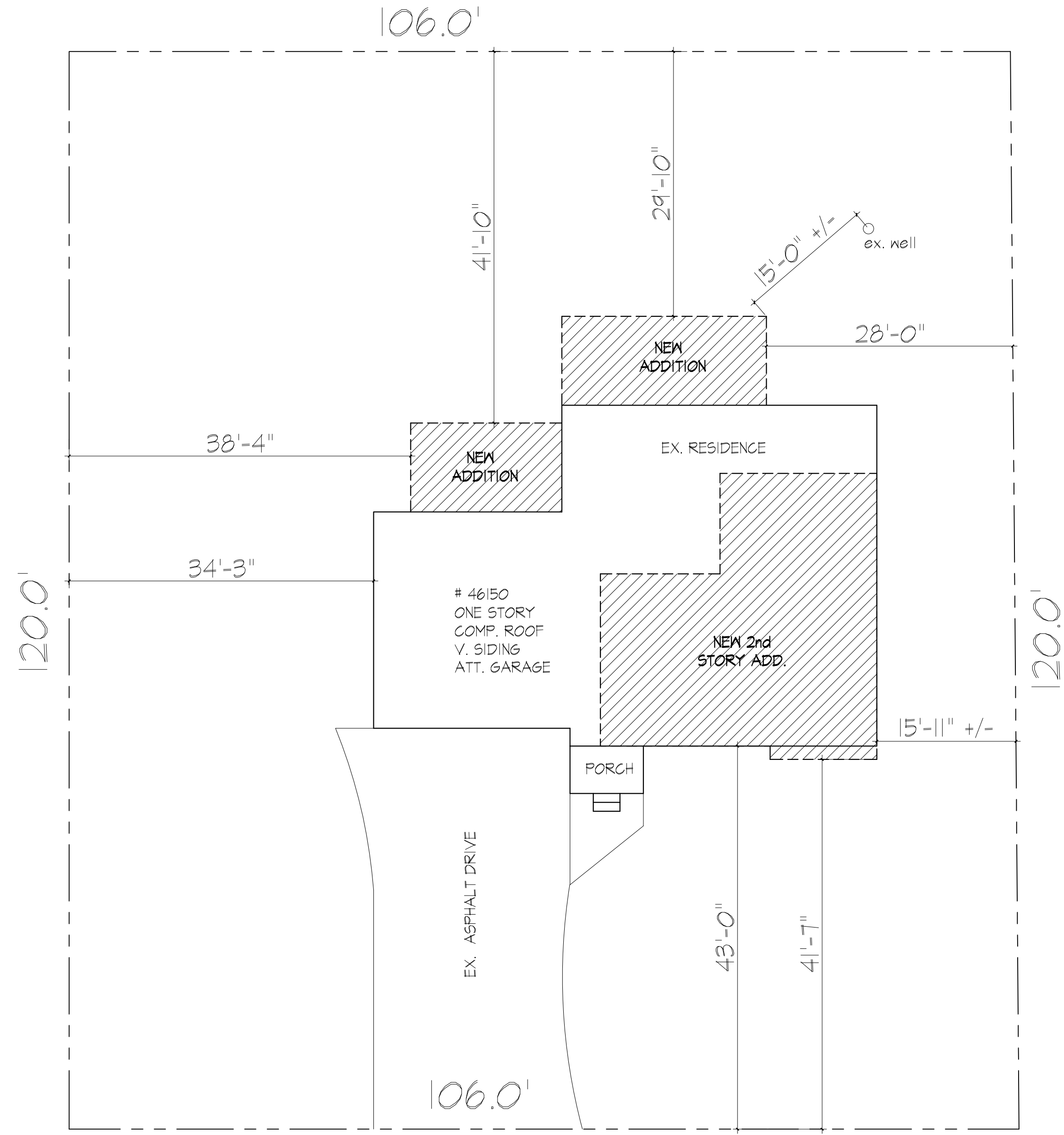

NEESON STREET - 60' WD.

PLOT PLAN

SCALE: 1" = 10'-0"



Custom Designs - Renovations - Additions & Homes

511 Elm Street
 Wyandotte, Michigan
 48192
 (313) 657-5127
 remarkhomedesigns@wyandotte.org

Remark Home Designs

SHEET DESCRIPTION:
PLOT PLAN

MR. & MRS. LOCKMAN RESIDENCE
 46150 Neeson Street
 Northville, Michigan

REVISIONS:
 3/22/2021

DRAWN BY:
 BRIAN M. KRAMER

FILE NAME:
 LOCKMAN.dwg

SHEET NUMBER:
 1

COPYRIGHT (C) 2020 REMARK HOME DESIGNS, L.L.C. DRAWINGS, AS INSTRUMENTS OF SERVICE, ARE AND SHALL REMAIN THE PROPERTY OF B. MICHAEL KRAMER, A.I.B.D. ANY USE OF THESE DRAWINGS WITHOUT THE EXPRESSED CONSENT CONSTITUTES AN INFRINGEMENT OF THE COPYRIGHT AND IS SUBJECT TO SEVERE LEGAL PENALTIES.



RIGHT ELEVATION

SCALE: 1/4" = 1'-0"



REAR ELEVATION

SCALE: 1/4" = 1'-0"



Custom Designs - Renovations - Additions & Homes

311 Elm Street
 Northville, Michigan
 48169
 (313) 657-5127
 remarkhomedesigns@gmail.com

Remark
 Home
 Designs

SHEET DESCRIPTION:
 ELEVATIONS

MR. & MRS. LOCKMAN RESIDENCE
 46150 Neeson Street
 Northville, Michigan

REVISIONS:
DRAWN BY: BRANK M. GRAHER
FILE NAME: LOCKMAN.dwg
SHEET NUMBER: 1

ALL RIGHTS RESERVED. NO PART OF THIS DOCUMENT MAY BE REPRODUCED OR TRANSMITTED IN ANY FORM OR BY ANY MEANS, ELECTRONIC OR MECHANICAL, WITHOUT PERMISSION IN WRITING FROM REMARK HOME DESIGNS. THIS DRAWING IS THE PROPERTY OF REMARK HOME DESIGNS AND IS NOT TO BE REPRODUCED, COPIED, OR USED FOR ANY OTHER PROJECT WITHOUT THE WRITTEN PERMISSION OF REMARK HOME DESIGNS.